

POCKET FRAME WITHOUT CASING

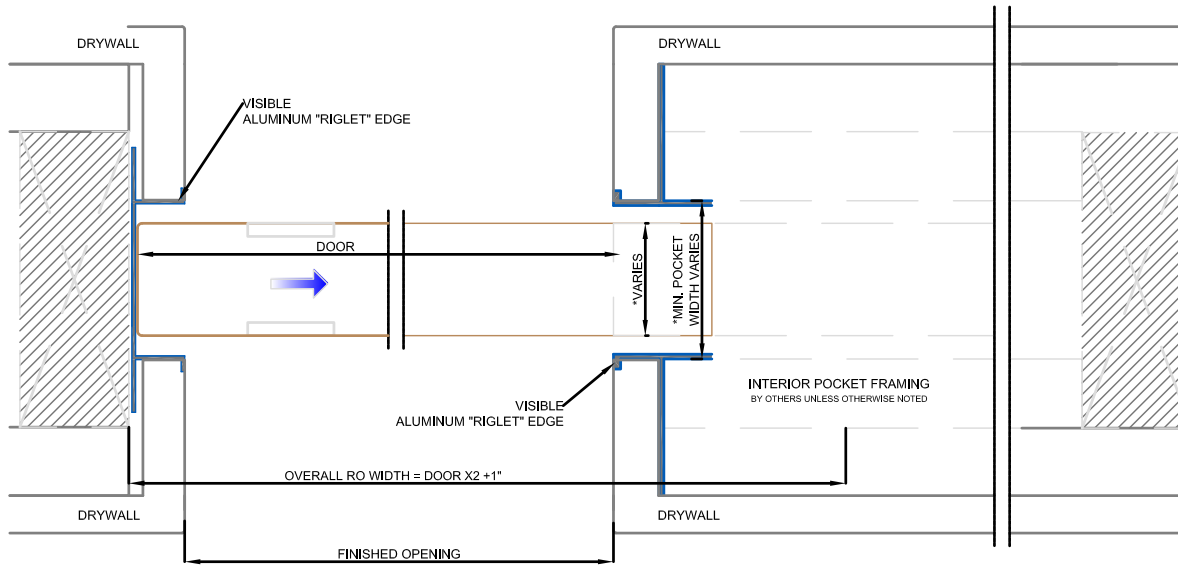

*DOORS UP TO 2438mm [96"] HEIGHT = 40mm [1 9/16"] DOOR THICKNESS
 DOORS OVER 2438mm [96"] HEIGHT = 48mm [1 7/8"] DOOR THICKNESS
 MINIMUM POCKET WIDTH = DOOR THICKNESS + 10mm [3/8"]

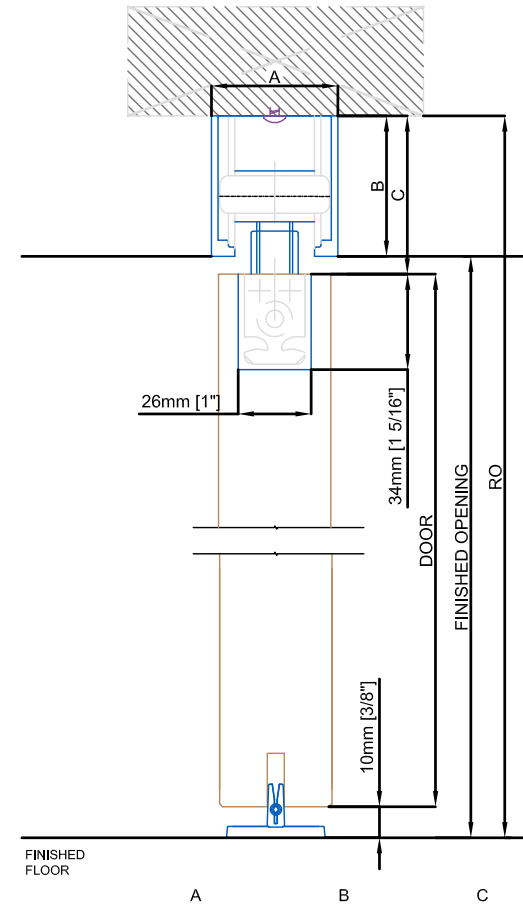

	A	B	C
HAWA JR. 80/B up to 80kg [176 Lbs]	34mm [1 5/16"]	40mm [1 9/16"]	46mm [1 13/16"] +/-3mm [1/8"]
HAWA JR. 120/B up to 120kg [265 Lbs]	45mm [1 3/4"]	50mm [1 15/16"]	56mm [2 3/16"] +/-3mm [1/8"]
HAWA JR. 160/B up to 160kg [353 Lbs]	53mm [2 1/16"]	62mm [2 7/16"]	70mm [2 3/4"] +/-3mm [1/8"]

PREPARED BY: C. ANDRYKA DATE: 05.AUGUST.2019

TECHNICAL DRAWINGS ARE SUBJECT TO CHANGE WITHOUT NOTICE.
 ALL MILLIMETER DIMENSIONS ARE EXACT AND SUPERSEDE INCH CONVERSIONS.

COPYRIGHT BARTELS DOORS, ALL RIGHTS RESERVED. REPRODUCTION OR OTHER USE OF THESE DESIGNS WITHOUT WRITTEN CONSENT OF BARTELS DOORS IS PROHIBITED.

Calculation:

- 10mm [3/8"] undercut

	RO	WIDTH	HEIGHT
DOOR	X	X / 2 - 25mm [1"]	X - C - 10mm [3/8"]
FINISHED OPENING	X	X / 2 - 57mm [2 1/4"]	X - B



1901 TIGERTAIL BLVD.
 DANIA BEACH, FL 33004
WWW.BARTELSDOORS.COM
 PHONE: 954.924.6137
 FAX: 954.924.6138

Glass Pocket

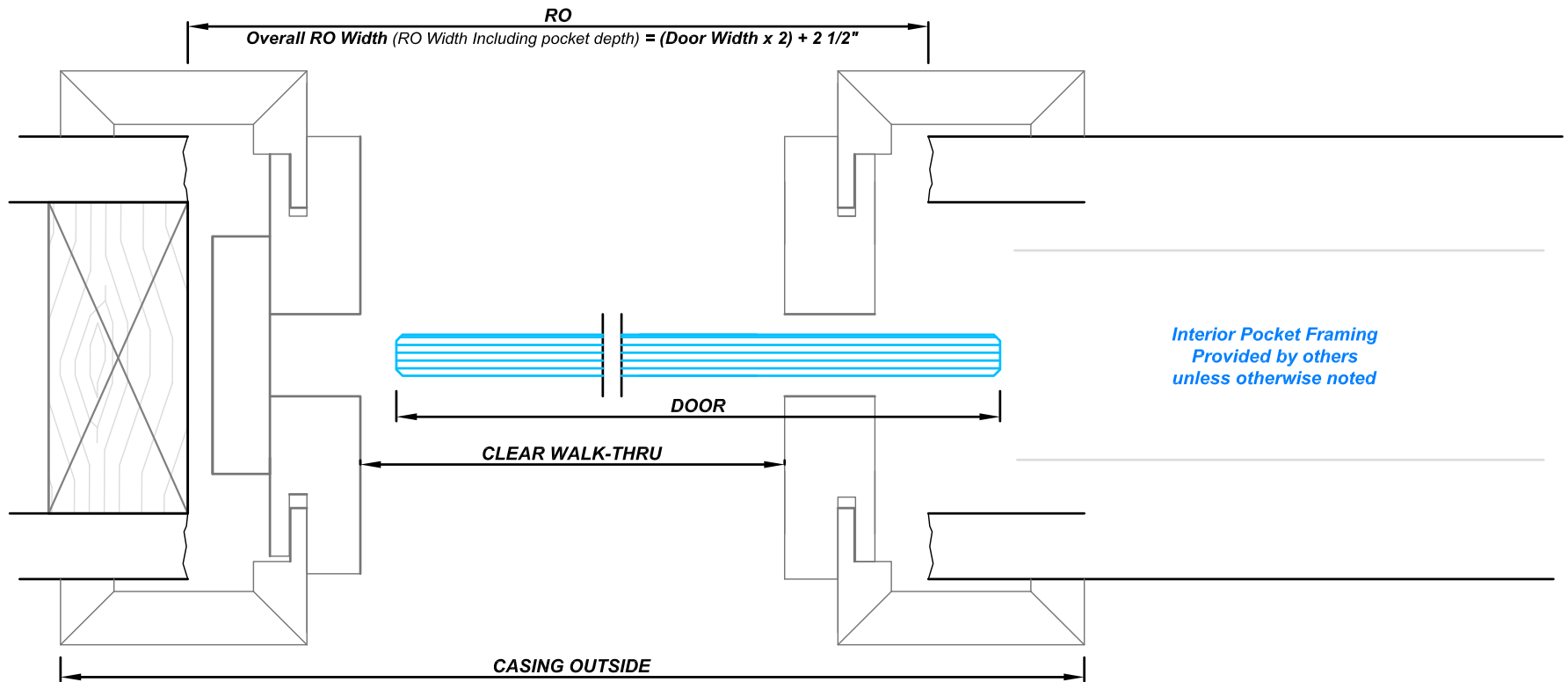

Calculation:

- 7mm [1/4"] undercut

	RO	CASING WIDTH	WIDTH	HEIGHT
DOOR	X		X - 32mm [1 1/4"]	X - 25mm [1"]
*CLEAR WALK-THRU	X		X - 76mm [3"]	X - 35mm [1 3/8"]
CASING OUTSIDE	X	2"	X + 51mm [2"]	X + 19mm [3/4"]
	X	2 3/8"	X + 70mm [2 3/4"]	X + 28mm [1 1/8"]
	X	2 3/4"	X + 89mm [3 1/2"]	X + 38mm [1 1/2"]

*ADA Compliant Information:

- RO WIDTH = 895mm [35 1/4"]
- Minimum DOOR WIDTH = 864mm [34"]

Dimensions consider the door slides completely inside of pocket!

PREPARED BY: C. ANDRYKA

DATE: 23.AUGUST.2016

**Technical drawings are subject to change without notice.
All Millimeter Dimensions are exact and supersede inch conversions.**

Copyright BARTELS Doors, all rights reserved. Reproduction or other use of these designs without written consent of BARTELS Doors is prohibited.

BARTELS DOORS & HARDWARE
MADE IN GERMANY

1901 Tigertail Blvd Dania Beach, FL 33004
Phone: 954.924.6137 Fax: 954.924.6138
www.bartelsdoors.com

Pocket Door

- 51mm [2"] / 60mm [2 3/8"] / 70mm [2 3/4"] casing width

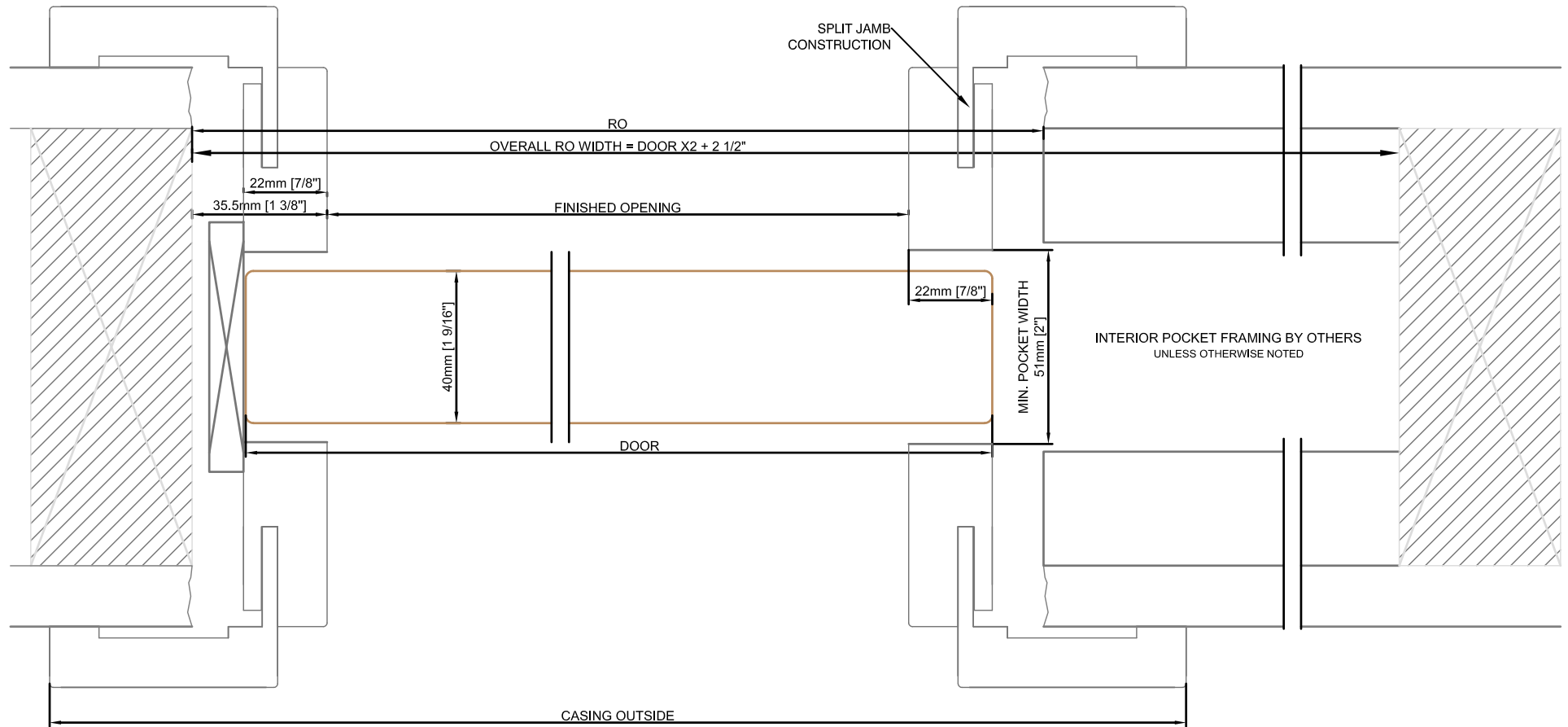

*ADA Compliant Information:

ADA REQUIRES MINIMUM 32" MEASURABLE CLEAR WALK-THRU

- MINIMUM RO WIDTH = 895mm [35 1/4"]
- MINIMUM DOOR WIDTH = 864mm [34"]

DIMENSIONS CONSIDER THE DOOR TO SLIDE COMPLETELY INSIDE THE POCKET!

PREPARED BY: C. ANDRYKA DATE: 31.JULY.2019

TECHNICAL DRAWINGS ARE SUBJECT TO CHANGE WITHOUT NOTICE.
ALL MILLIMETER DIMENSIONS ARE EXACT AND SUPERSEDE INCH CONVERSIONS.

COPYRIGHT BARTELS DOORS, ALL RIGHTS RESERVED. REPRODUCTION OR OTHER USE OF THESE DESIGNS WITHOUT WRITTEN CONSENT OF BARTELS DOORS IS PROHIBITED.

Calculation:

- 7mm [1/4"] undercut

	RO	CASING WIDTH	WIDTH	HEIGHT
DOOR	X		X - 32mm [1 1/4"]	X - 25mm [1"]
FINISHED OPENING	X		X - 76mm [3"]	X - 35mm [1 3/8"]
CASING OUTSIDE	X	2"	X + 51mm [2"]	X + 19mm [3/4"]
	X	2 3/8"	X + 70mm [2 3/4"]	X + 28mm [1 1/8"]
	X	2 3/4"	X + 89mm [3 1/2"]	X + 38mm [1 1/2"]



1901 TIGERTAIL BLVD.
DANIA BEACH, FL 33004

WWW.BARTELSDOORS.COM

PHONE: 954.924.6137

FAX: 954.924.6138